

ITEM NO.	PART NUMBER	DESCRIPTION	QTY.
1	PU-P16659D5	SIDE PORT PUMP ONLY	1
2	PU-MANO6D	6 GROOVE CLUTCH	1
3	AD-4603-16-20	45° ADAPTER BEADED ORB	1
4	AD-6802 10-12	ADAPTER 10MJ x 12MB 45	1
5	EL-SK-100	PUMP SWITCH KIT	1

REVISIONS			
REV.	DESCRIPTION	DATE	APPROVED
A	INITIAL RELEASE	1/22/2019	
B	UPDATED PART NUMBERS AND ADDED ITEM NO.5	11/8/2023	KD (BB)

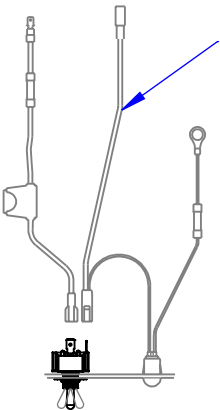

EL-SK-100: QTY 1
"SWITCH KIT, DASH"
SEE DWG 10-0906 FOR
MORE DETAILS

PU-SP4-11-45-6A

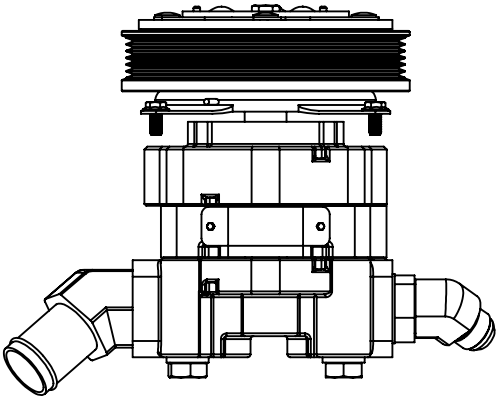
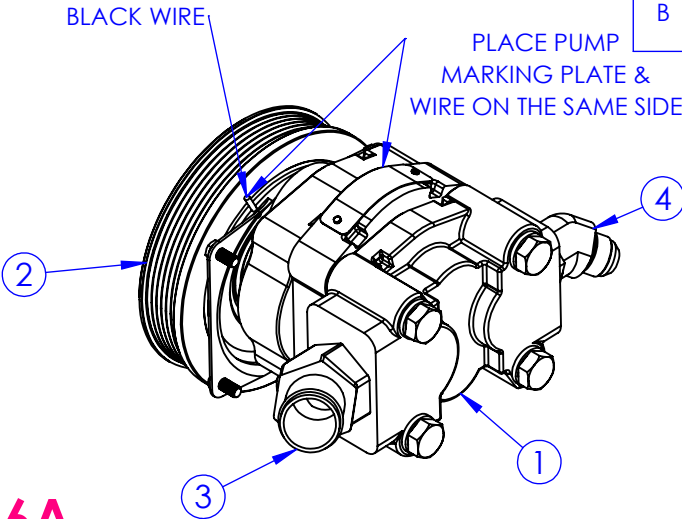

RECOMMENDED TORQUE, ABOUT 20ftlbs

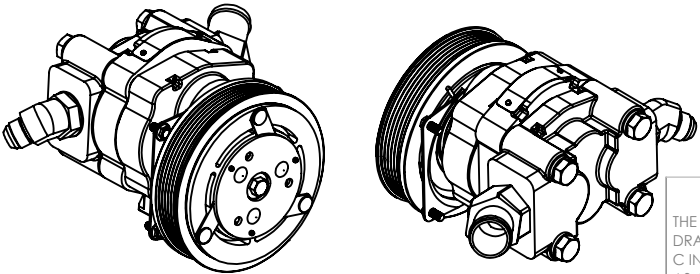
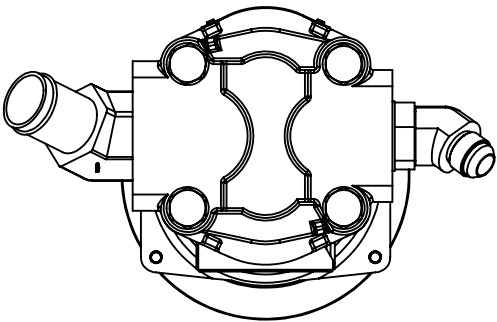
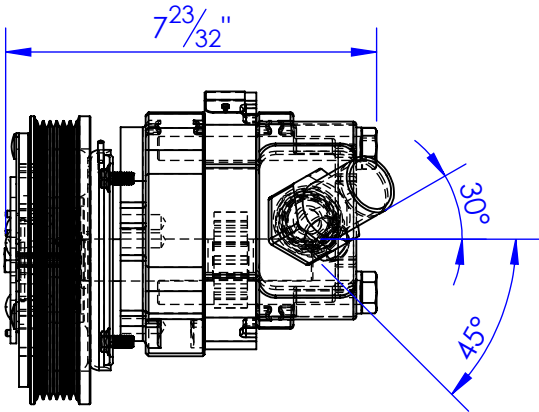
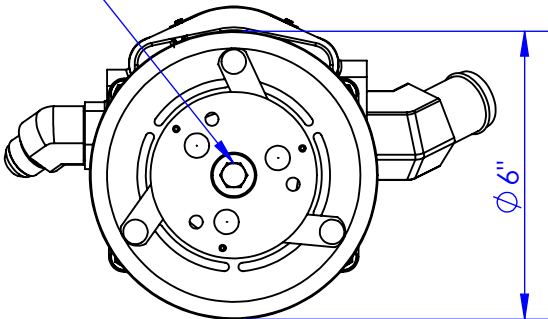

PROPRIETARY AND CONFIDENTIAL
THE INFORMATION CONTAINED IN THIS
DRAWING IS THE SOLE PROPERTY OF TRIPLE
C INC. ANY REPRODUCTION IN PART OR
AS A WHOLE WITHOUT THE WRITTEN
PERMISSION OF TRIPLE C INC. IS PROHIBITED.

DIMENSIONS ARE IN INCHES TOLERANCES: FRACTIONAL ±1/16 ANGULAR: MACH ±1 BEND ± TWO PLACE DECIMAL ±010 THREE PLACE DECIMAL ±005			NAME	DATE
		DRAWN	ETHAN	11/8/2023
		PART #	PU-SP4-11-45-6A	
		ASM #		
		COMMENTS:		
MATERIAL --		6 GROOVE SIDE PORT PARKER PUMP 45°		
DO NOT SCALE DRAWING				

P.O. BOX 248,
SABETHA, KS 66534



SIZE A	DWG. NO. 10-0931-24 B	REV. B
SCALE: 1:4	WEIGHT: --	SHEET 1 OF 1